

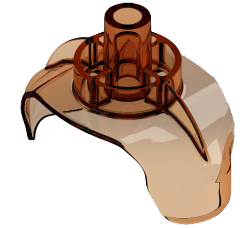

LIMPET DEPLOYMENT ACCESSORY OPTIONS

SPECIFICATION

| Accessories | Details | Dimensions |
|-----------------------|--|-------------------------|
| Titanium Dart Anchors | 3-petal | 45 mm L x 22 mm W x 4 g |
| | 6-petal | 68 mm L x 24 mm W x 6 g |
| Deployment Cup | SPOT-365 | 59 L x 38 W x 42 H (mm) |
| | SPLASH10-333 | 51 L x 43 W x 39 H (mm) |
| | SPLASH10-F-333 | 51 L x 43 W x 39 H (mm) |
| Airgun Arrow | For use with 13 mm bore Dan-Inject CO ₂ rifle | 35 in L |
| Crossbow Arrow | Flatback nock | 20 in L |



SPOT-365
Deployment Cup



SPLASH10-333
Deployment Cup



SPLASH10-F-333
Deployment Cup

LIMPET deployment accessories available for Wildlife Computers LIMPET tags only.



Model: SPOT-365 Deployment Cup with Crossbow Arrow



Model: SPLASH10-333 with 6-petal Ti Anchor with Air Gun Arrow



Ti Dart Anchors:
6- and 3-petal

tags@wildlifecomputers.com
WildlifeComputers.com
 +1 (425) 881-3048

8310 154th Ave NE, Suite 150
 Redmond, WA, 98052 USA

This is a small representation of our available tags. Tag features and specifications subject to change without notice. Comparative scale is approximate. Tags are not shown to scale. Lifespan estimates rely on programming, battery variability, temperature, power settings, features utilized, etc. © Wildlife Computers. All rights reserved. This is proprietary information and not to be reproduced, copied, or shared without written permission.

v. 22-06

To Learn More Call: +1 (425) 881-3048 or Email: tags@wildlifecomputers.com