



ADULT HARD-SHELL SEA TURTLE TAG SUITE

SPECIFICATION

PG 1 OF 2

Model	Argos	Fastloc®	Depth	Temperature	Light Level	Life (days) ¹	Frontal Area (mm ²)	L x W x H (mm) ²	Weight (g)
SPOT-352	✓			✓		914	1508	72 x 56 x 22	129
SPOT-375	✓			✓		914	1480	99 x 55 x 21	152
SPOT-395	✓			✓		740	868	75 x 40 x 19	86
SPLASH10-351	✓		✓	✓	Optional	260	1551	86 x 55 x 25	149
SPLASH10-BF-351	✓	✓		✓	Optional	242	1551	86 x 55 x 25	149
SPLASH10-F-351	✓	✓	✓	✓	Optional	242	1551	86 x 55 x 25	149

1. The above estimated tag life relies on battery variability, temperature, power settings, features utilized, etc. Life estimates are calculated using manufacturers' specifications and assumes 250 transmissions per day and, where applicable, 24 Fastloc® acquisitions per day.
2. Height is measured from tag bottom to top surface of the tag body, excluding the additional abrasion-resistant epoxy protection.

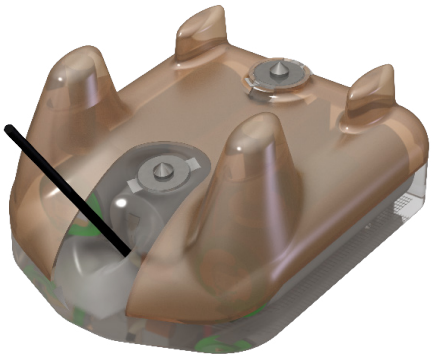

Model: SPOT-352

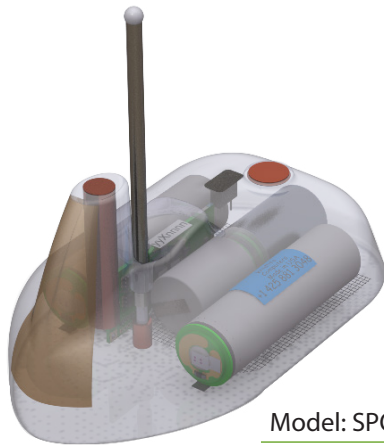

Model: SPOT-375

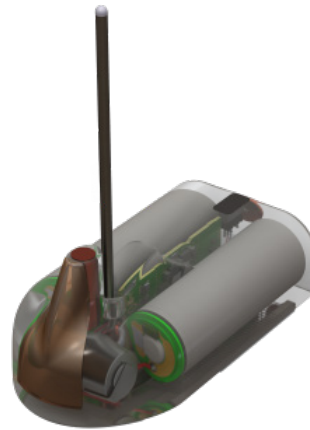

Model: SPOT-395

tags@wildlifecomputers.com
 WildlifeComputers.com
 +1 (425) 881-3048

8310 154th Ave NE, Suite 150
 Redmond, WA, 98052 USA

v. 20-01 7.1

This is a small representation of our available tags. Tag features and specifications subject to change without notice. Comparative scale is approximate. Tags are not shown to scale. © Wildlife Computers. All rights reserved.

To Learn More Call: +1 (425) 881-3048 or Email: tags@wildlifecomputers.com

Model	Argos	Fastloc [®]	Depth	Temperature	Light Level	Life (days) ¹	Frontal Area (mm ²)	L x W x H (mm ²)	Weight (g)
SPLASH10-344	✓		✓	✓	Optional	520	2430	86 x 86 x 28	231
SPLASH10-BF-344	✓	✓		✓	Optional	485	2430	86 x 86 x 28	231
SPLASH10-F-344	✓	✓	✓	✓	Optional	485	2430	86 x 86 x 28	231
SPLASH10-385	✓		✓	✓	Optional	540	2234	121 x 66 x 51	290
SPLASH10-BF-385	✓	✓		✓	Optional	503	2234	121 x 66 x 51	290
SPLASH10-F-385	✓	✓	✓	✓	Optional	503	2234	121 x 66 x 51	290

1. The above estimated tag life relies on battery variability, temperature, power settings, features utilized, etc. Life estimates are calculated using manufacturers' specifications and assumes 250 transmissions per day and, where applicable, 24 Fastloc[®] acquisitions per day.

2. Height is measured from tag bottom to top surface of the tag body, excluding the additional abrasion-resistant epoxy protection.

Model:
SPLASH10-351/
BF-351/ F-351



Model:
SPLASH10-344/
BF-344/ F-344

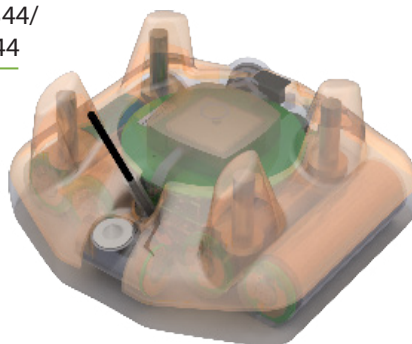

Model:
SPLASH10-385/
BF-385/ F-385

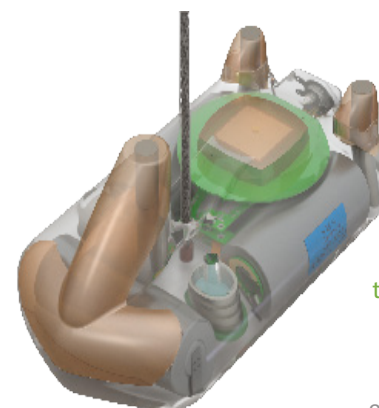

tags@wildlifecomputers.com
WildlifeComputers.com
+1 (425) 881-3048

8310 154th Ave NE, Suite 150
Redmond, WA, 98052 USA

This is a small representation of our available tags. Tag features and specifications subject to change without notice. Comparative scale is approximate. Tags are not shown to scale. © Wildlife Computers. All rights reserved.

v. 20-01 7.1